

NOTES:
 1. PART SHALL BE FREE OF BURRS AND SHARP EDGES
 2. DIMENSIONS IN [] ARE MILLIMETERS

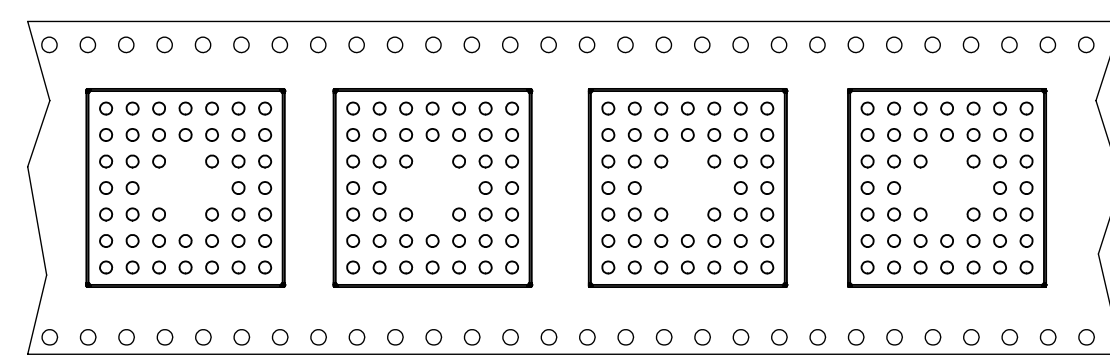

CARRIER TAPE

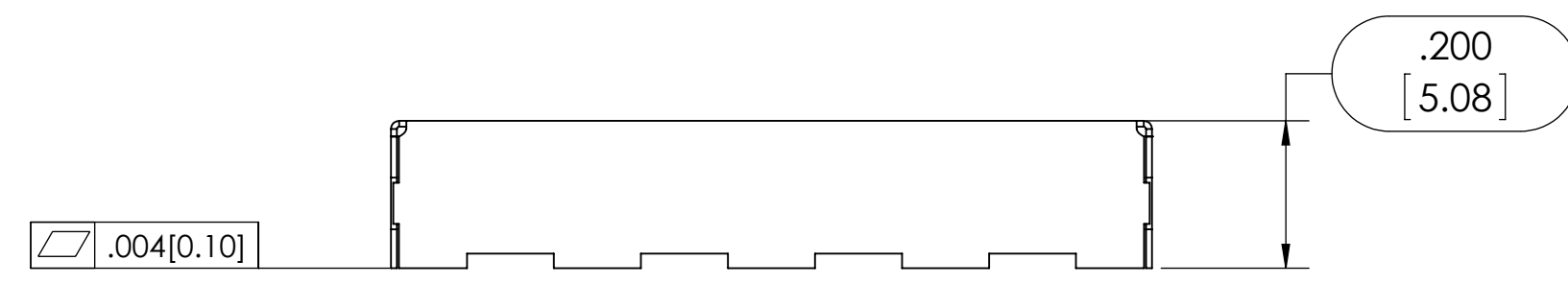
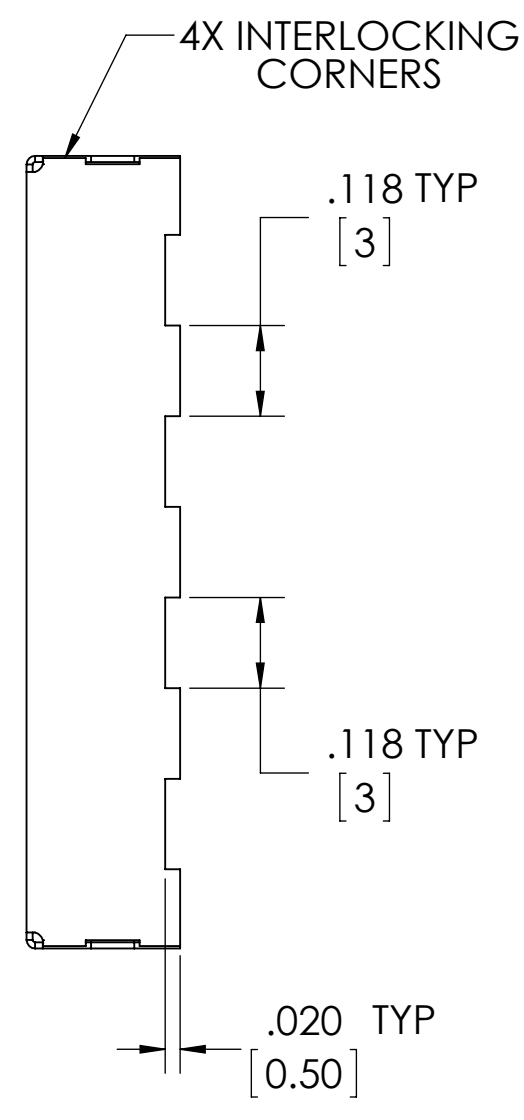
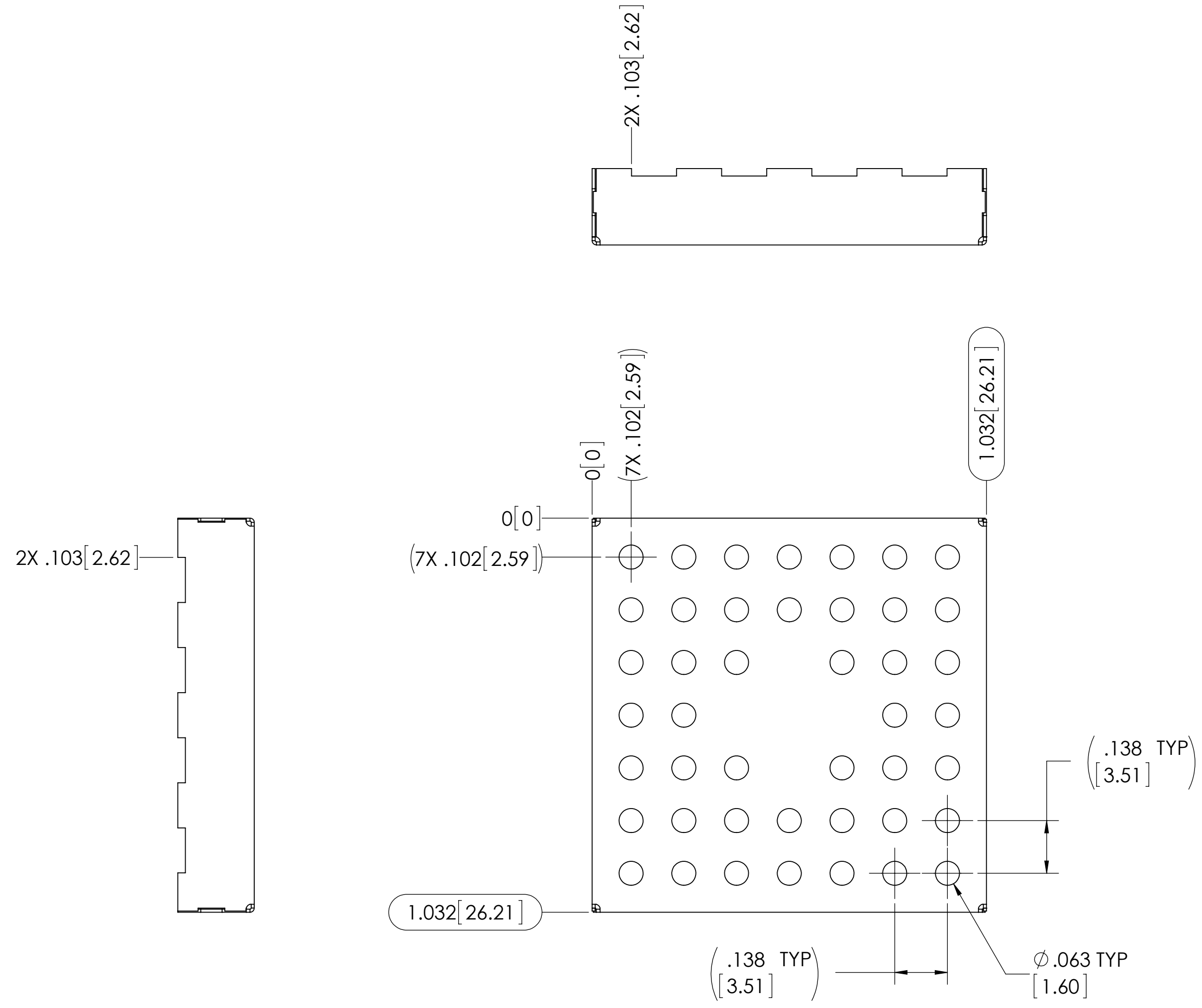

CARRIER TAPE SPECIFICATIONS						
PART NUMBER	DESCRIPTION	OVERALL DIMENSION	OVERALL HEIGHT	CARRIER TAPE WIDTH	CARRIER TAPE PITCH	PARTS PER REEL
SMS-103	ONE PIECE SHIELD	1.032 x 1.032 [26.21 x 26.21]	.200 [5.08]	44 mm	32 mm	300

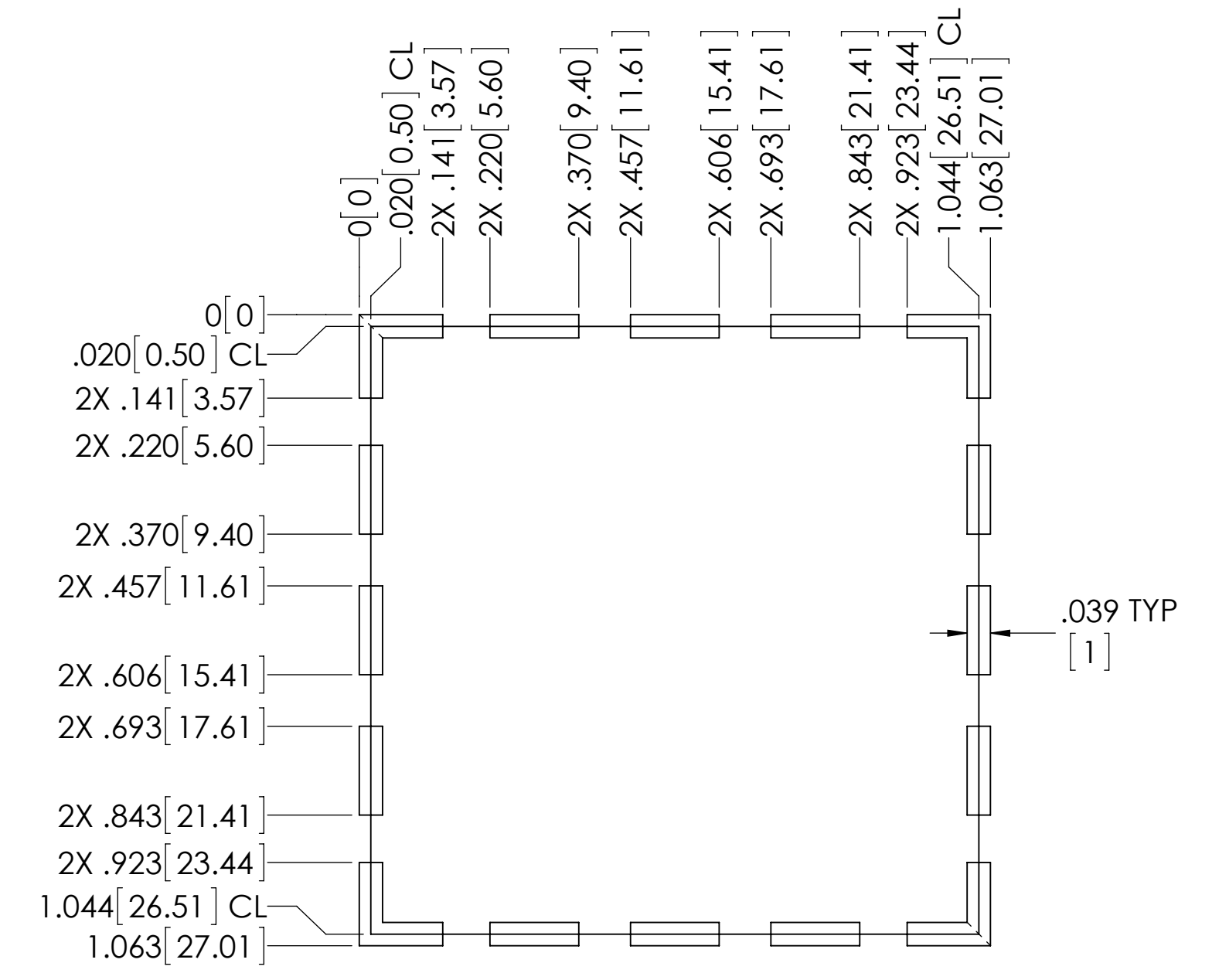

TRACE PATTERN

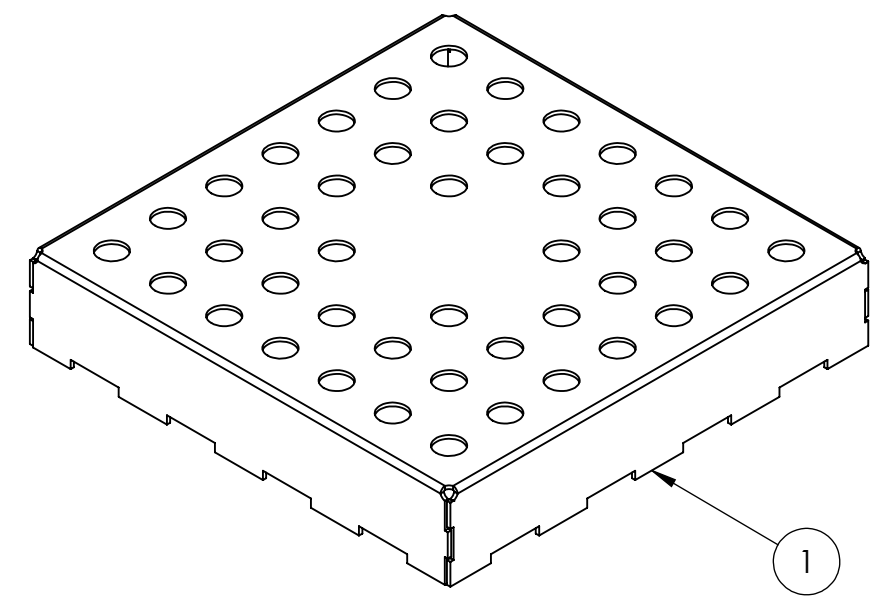

THIS DOCUMENT CONTAINS PROPRIETARY INFORMATION OWNED BY LEADTECH OR DEVELOPED AT ITS OWN PRIVATE EXPENSE AND MAY NOT BE USED, REPRODUCED OR DISCLOSED IN WHOLE OR IN PART FOR ANY PURPOSE INCLUDING DESIGN, MANUFACTURE OR PROCUREMENT WITHOUT THE WRITTEN PERMISSION OF LEADTECH. LEADTECH DOES NOT GUARANTEE OR WARRANT THE PERFORMANCE CHARACTERISTICS.

ITEM NO. 1	PART NUMBER SMS-103	DESCRIPTION ONE PIECE SHIELD	QTY. 1
UNLESS OTHERWISE SPECIFIED: - ALL DIMENSIONS ARE IN INCHES - PART SHALL BE FREE OF BURRS AND SHARP EDGES - ALL DIMENSIONS SHOWN APPLY BEFORE PLATING AND COATINGS - ROHS COMPLIANT PER EU DIRECTIVE 2011/65/EU - POI = POINT OF INTERSECTION		THIRD ANGLE PROJECTION 	 a HEICO company The Leading Edge in PAM Manufacturing Technology
DRAWN BY: TGS 7/14/11 APPROVED BY: -		TITLE: SURFACE MOUNT SHIELD ONE PIECE	
FRSHE: MATTE	SCALE: 4:1	DWG. NO.: SMS-103	REV: B
MATERIAL: .008 [0.20] - PRE TIN STEEL	CAGE CODE: 4J674	SHEET: 1 OF 1	